



HRL-0050-1 HEATLESS  
DESICCANT AIR DRYER  
GENERAL ARRANGEMENT

TOLERANCES UNLESS  
OTHERWISE SPECIFIED:

- FRACTIONS = ± 1/4 "
- ANGLES = ± 3°
- INCHES = ± 1/2 "
- FINISH = 250

THE SPECIFICATIONS AND DRAWINGS DISCLOSED HEREIN ARE THE SOLE PROPERTY OF ALTEC AIR, AND SHALL NOT BE COPIED OR USED AS THE BASIS FOR SALE OR MANUFACTURE WITHOUT EXPRESS WRITTEN PERMISSION.

REVISION LOG

REV.	ECO.	DESCRIPTION	DATE	APPROVED
F	1162	PRODUCTION UPDATES	7/13/2021	WS

DRAWING NO. **AT20-391** REV. **F**

DRAWN: MR DATE: 2/23/2015  
CHECKED: DATE: SCALE: N/A SHEET: 1 OF 2

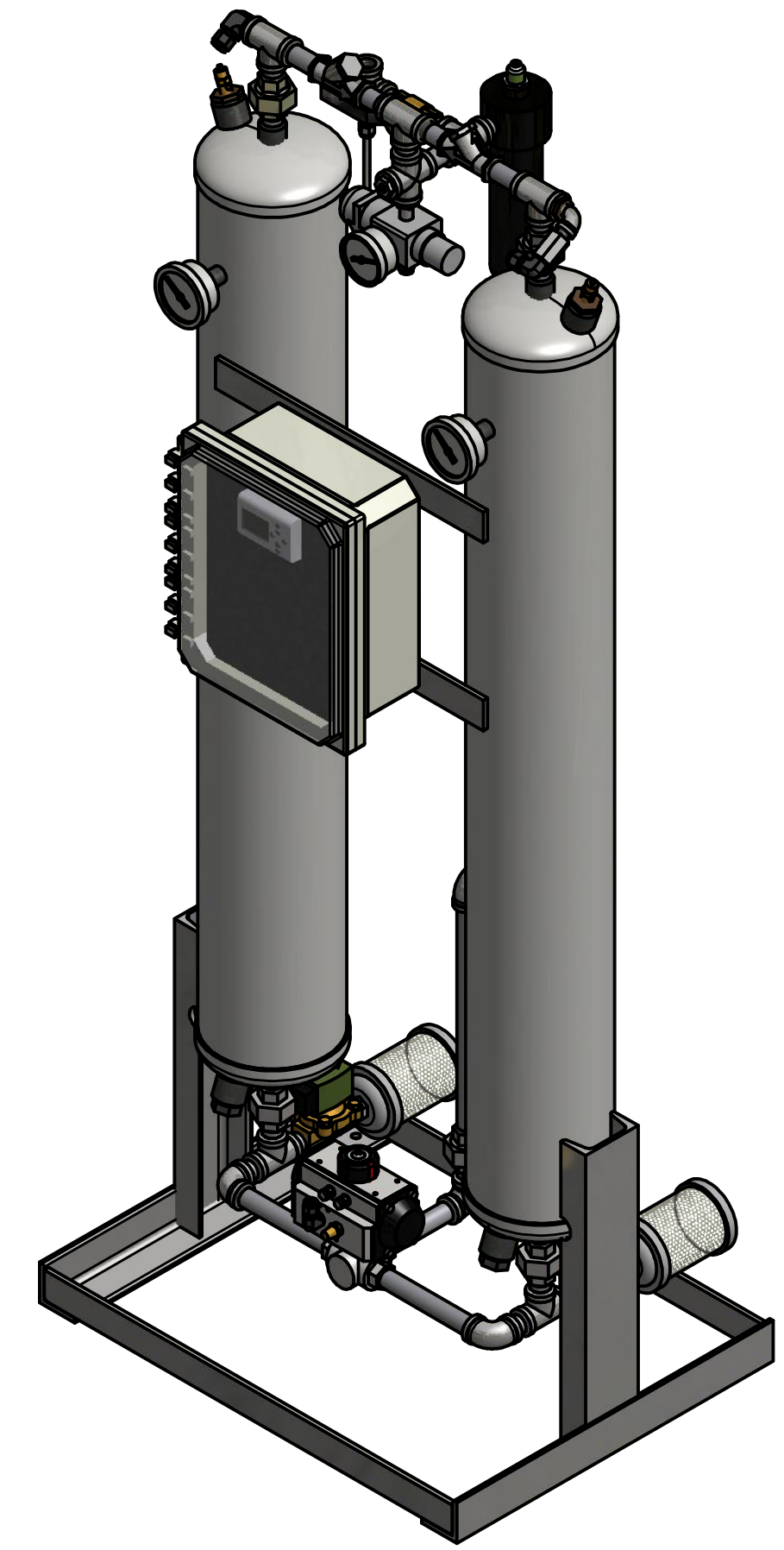
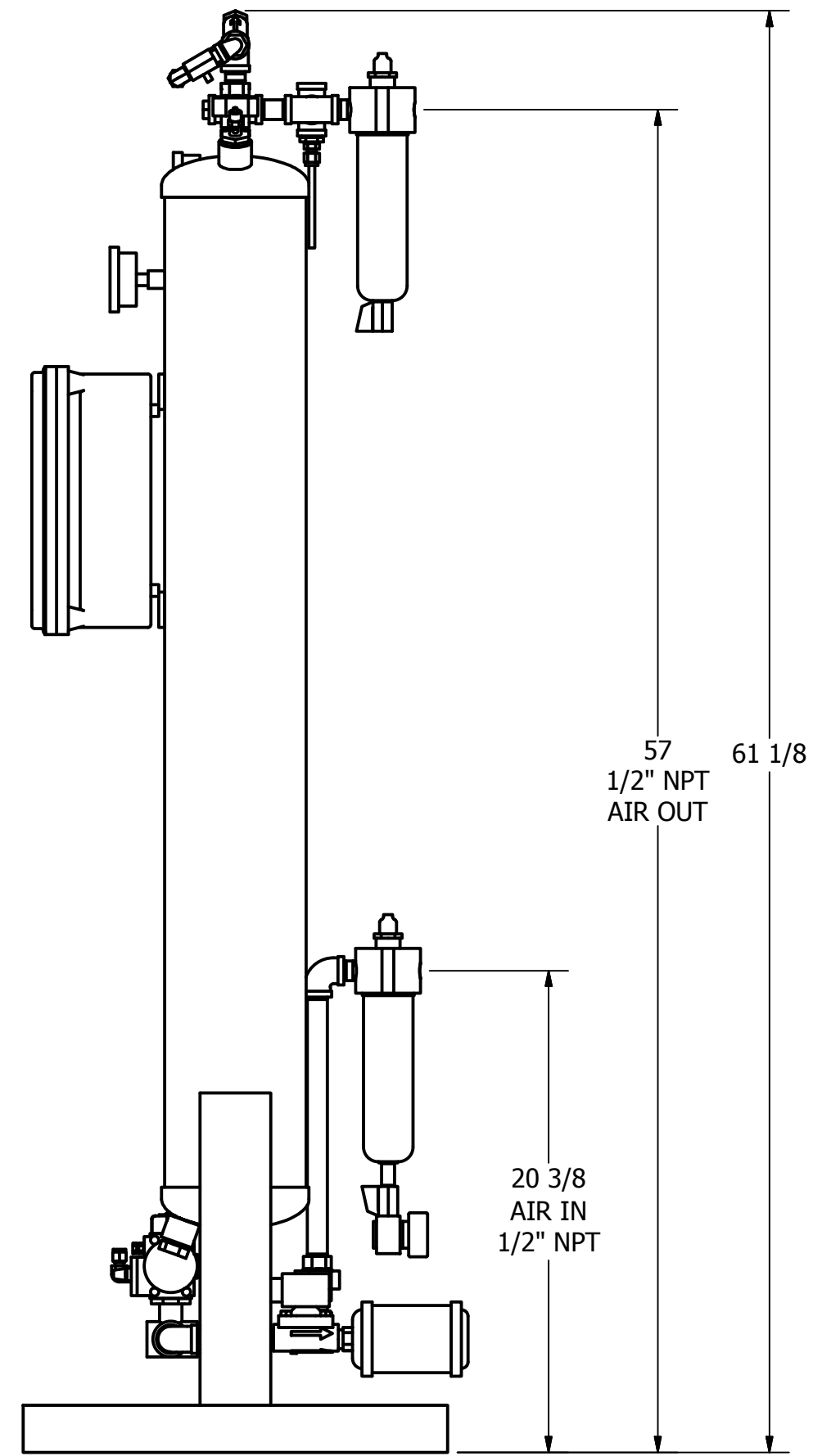
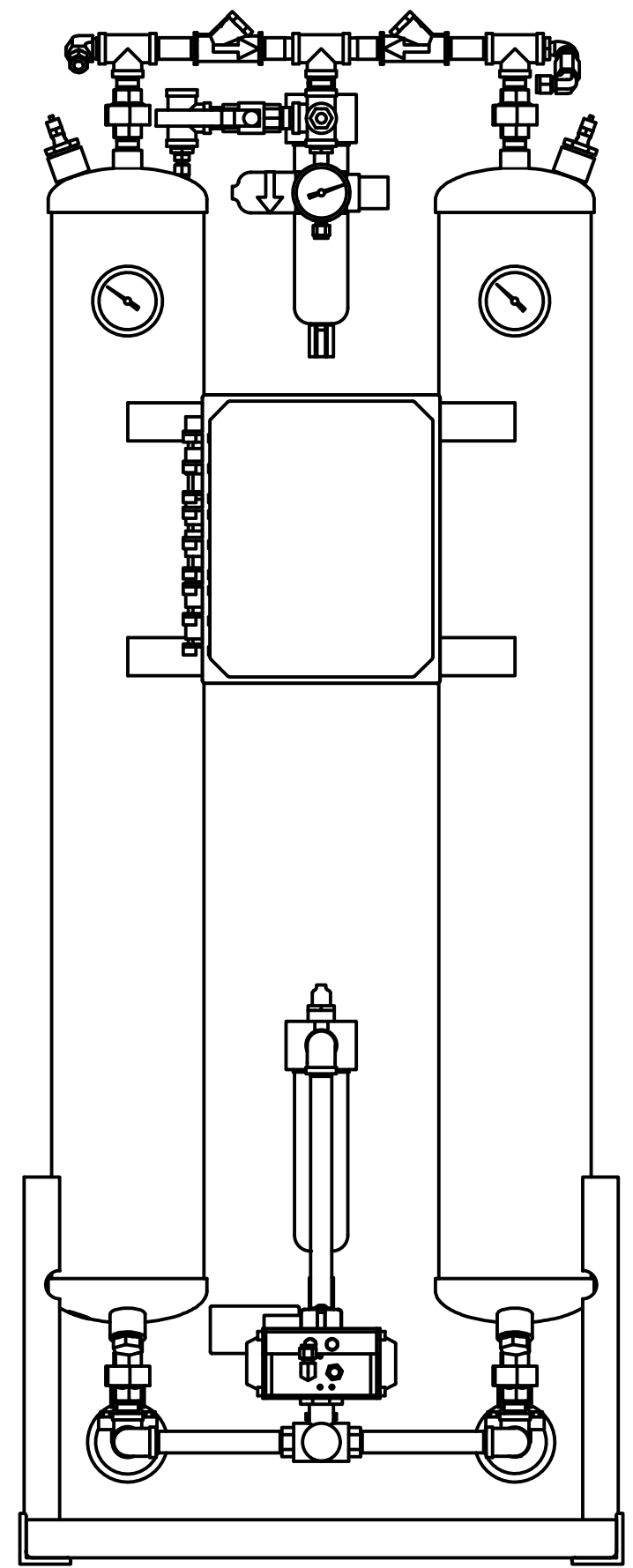
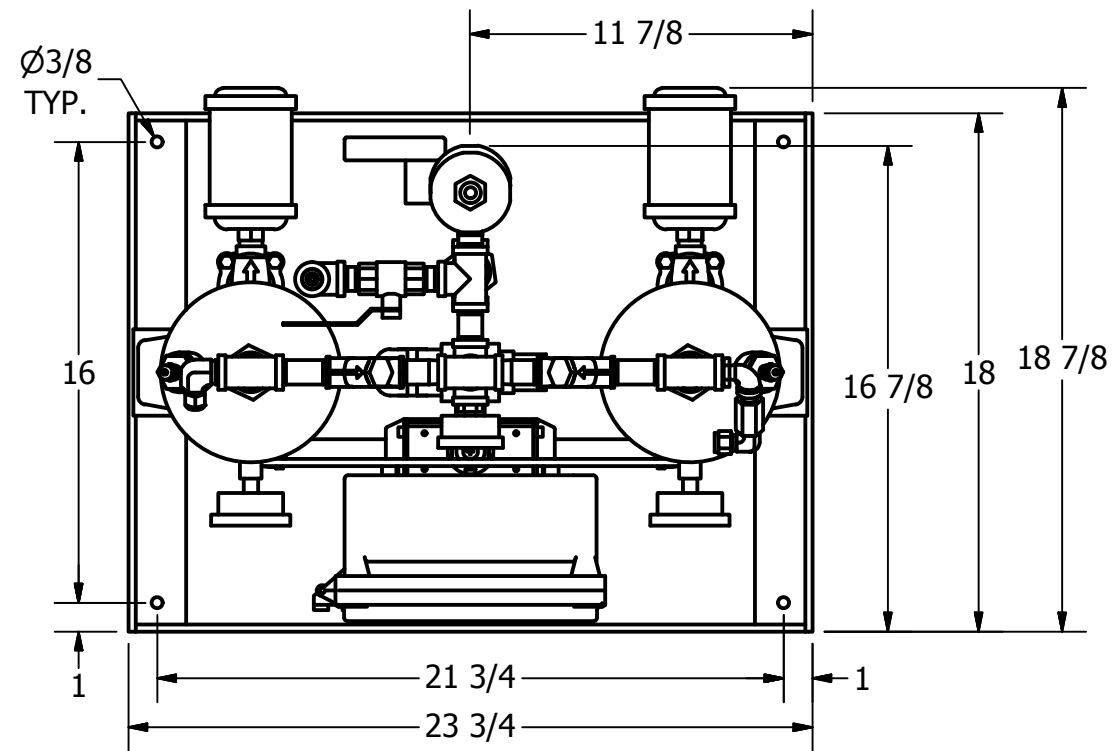

**PRELIMINARY**



# HRL-0050-1 HEATLESS DESICCANT AIR DRYER GENERAL ARRANGEMENT

TOLERANCES UNLESS  
OTHERWISE SPECIFIED:

FRACTIONS = ± 1/4 "  
ANGLES = ± 3°  
INCHES = ± 1/2 "  
FINISH = 250

THE SPECIFICATIONS AND DRAWINGS DISCLOSED HEREIN ARE THE SOLE PROPERTY OF ALTEC AIR, AND SHALL NOT BE  
COPIED OR USED AS THE BASIS FOR SALE OR MANUFACTURE WITHOUT EXPRESS WRITTEN PERMISSION.

### REVISION LOG

REV.	ECO.	DESCRIPTION	DATE	APPROVED
F	1162	PRODUCTION UPDATES	7/13/2021	WS

DRAWING NO.

**AT20-391**

REV.  
**F**

DRAWN: MR  
CHECKED:

DATE: 2/23/2015  
DATE:

SCALE: N/A

SHEET: 2 OF 2

### PARTS LIST

ITEM	QTY	DESCRIPTION
1	2	CHECK VALVE, OUTLET
2	1	PARTICULATE AFTER-FILTER
3	1	DEW POINT MONITOR (OPTIONAL)
4	1	MOISTURE INDICATOR
5	1	PRESSURE REGULATOR, CONTROL
6	1	PRESSURE GAUGE, CONTROL
7	1	NEEDLE VALVE, PURGE
8	2	RELIEF VALVE, TANK
9	2	PRESSURE GAUGE, TANK
10	1	3 WAY BALL VALVE, INLET
11	1	COALESCER PRE-FILTER
12	1	TIMED DRAIN
13	2	SOLENOID, EXHAUST
14	2	MUFFLER, EXHAUST
15	55 LBS	DESICCANT

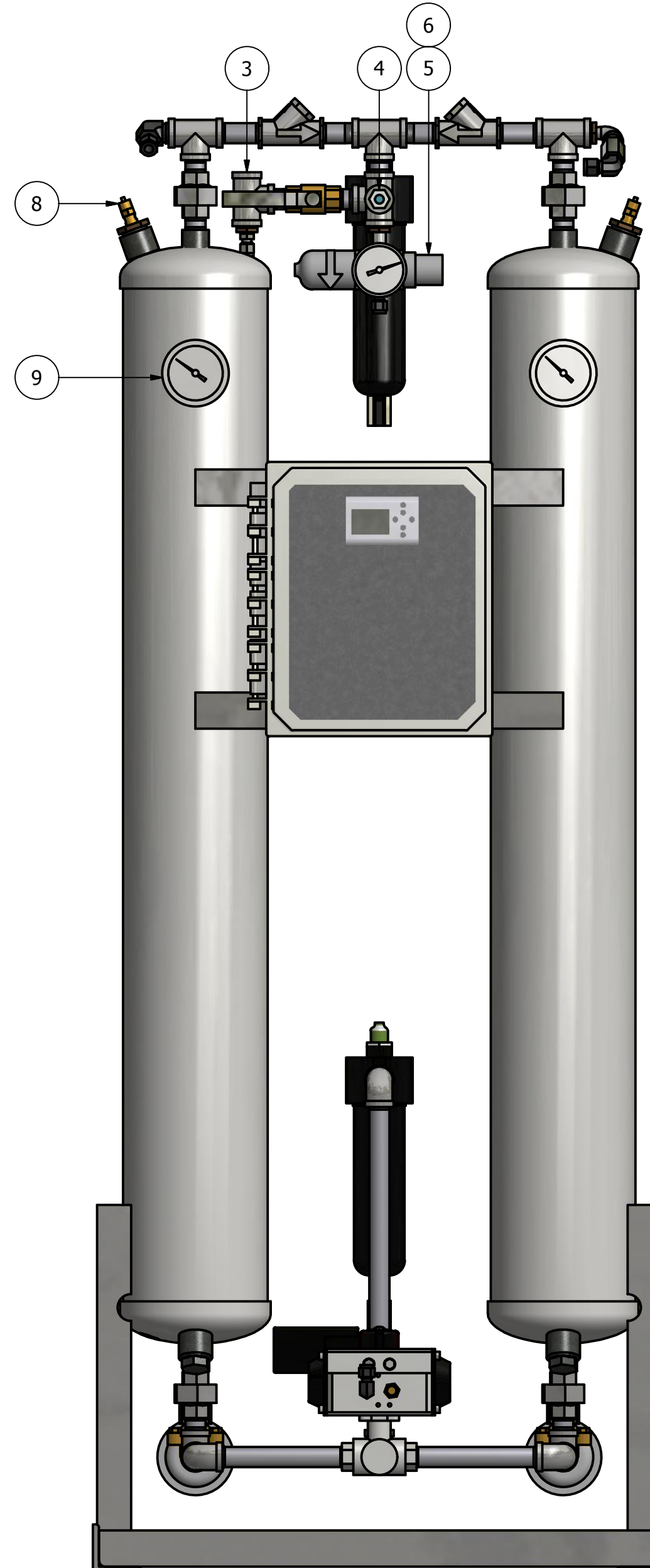
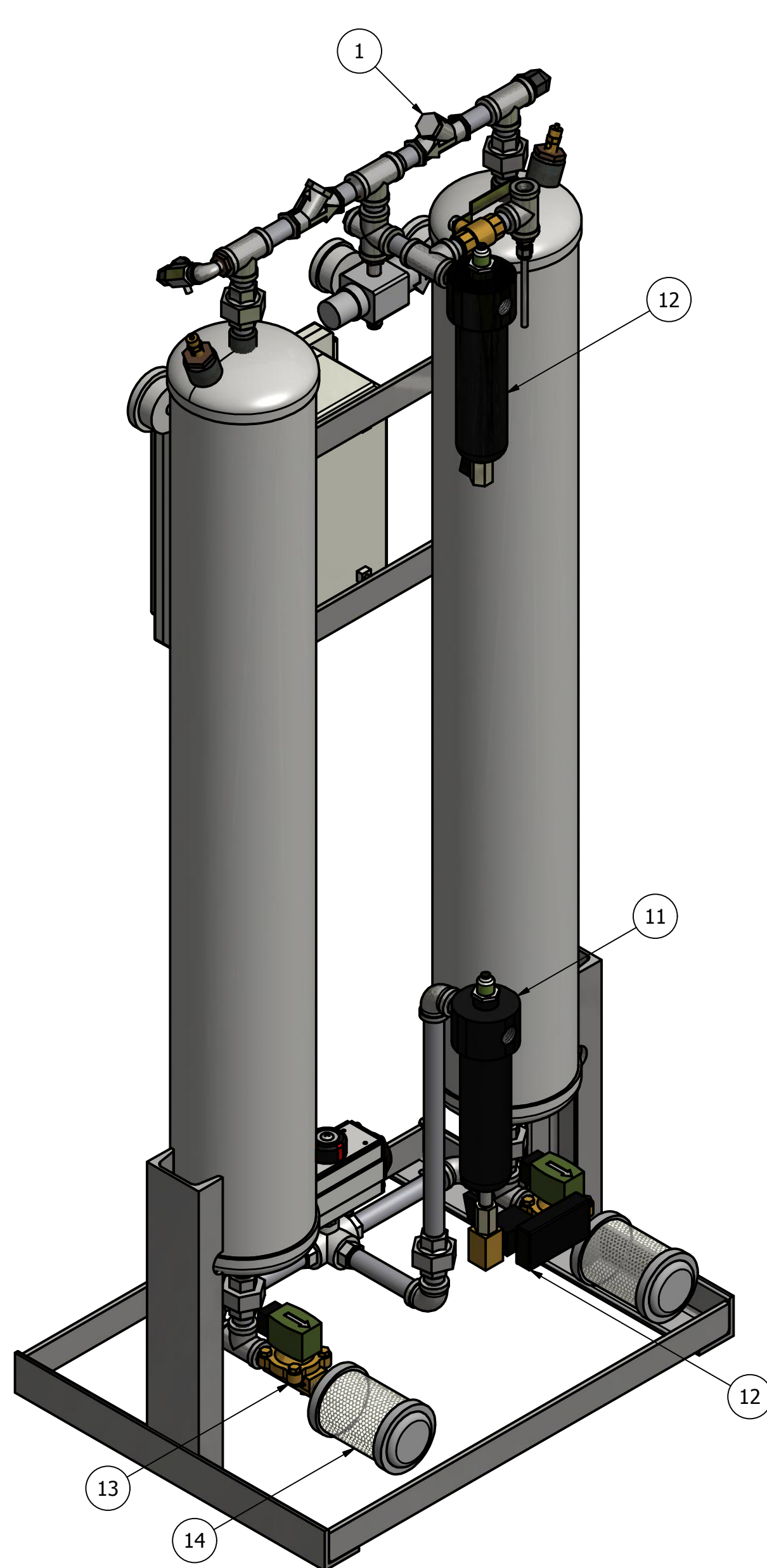

**PRELIMINARY**